

# Fittings

**BOAT RING**

12 x 80 mm  
12 x 120 mm  
12 x 200 mm  
16 x 200 mm  
16 x 260 mm  
Hot dip galvanised steel

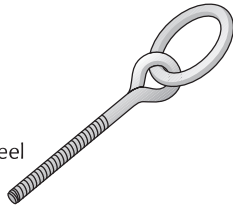

**BOLLARD**

Base: 150 x 150 mm  
Height: 175 mm  
Fixing: no. 4 M12  
Stainless steel  
Strength: 25 kN

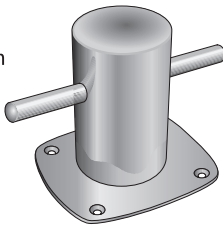

**BOX HINGE**

Base: 160 x 150 mm  
Fixing: no. 4 M12  
Hinge pin: M16  
Hot dip galvanised

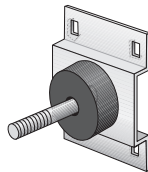

**ANCHORING RING TYPE 2 / TYPE 3**

18 mm / 13 mm  
Fixing: M20 / M16  
Hot dip galvanised

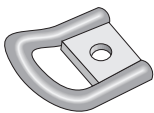

**ANCHORING HOOK**

9 mm  
Stainless steel

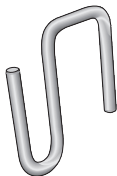

**SHACKLE**

12 mm, 16 mm, 20 mm,  
22 mm, 24 mm, 28 mm  
Hot dip galvanised



**BOAT RING**

12/200 mm  
16/200 mm  
16/260 mm  
Includes nut and washer  
Stainless steel



**BOAT RING**

Screw 12 mm  
Hot dip galvanised steel

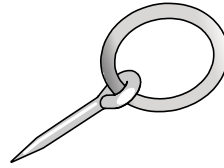

**SUPER YACHT BOLLARD 61003000**

Aluminium  
Base: 108 x 465 mm  
Height: 157 mm  
Fixing: no. 3 M20  
Strength: 75 kN

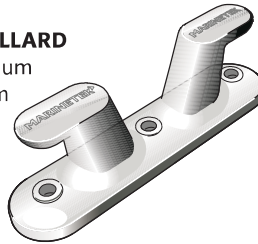

**MEGA YACHT BOLLARD**

Base: 170 x 495 mm  
Height: 152 mm  
Fixing: no. 6 M20  
Stainless steel  
Strength: 100 kN

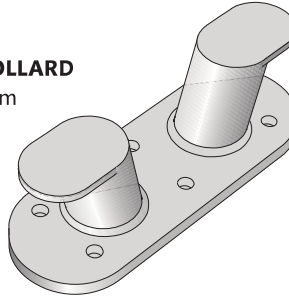

**HINGE STEEL TYPE 1 HINGE STEEL TYPE 2**

6 x 60 mm	8 x 80 mm
Fixing: M12	Fixing: M16
Hinge pin: M16	Hinge pin: M20
Hot dip galvanised	Hot dip galvanised

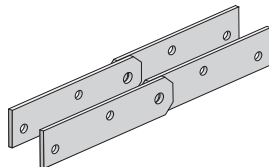

**ANCHORING EYE FOR ROCK**

20 mm  
22 mm  
Hot dip galvanised

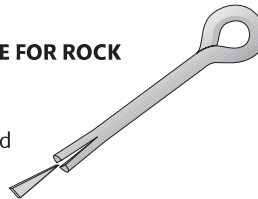

**FLEXIBLE SHORE FIXING**

250 kg  
500 kg  
1000 kg



**FLIP-UP CLEAT**

Base: 90 x 150 mm  
Height: 60 mm  
Fixing: no. 2 M8  
Aluminium

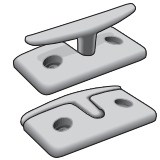

**HEAVY DUTY CLEAT**

Base: 60 x 220 mm  
Height: 95 mm  
Fixing: no. 2 M12  
Aluminium  
Strength: 25 kN

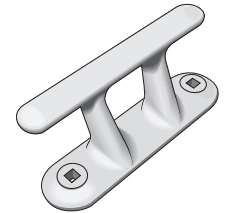

**PREMIER CLEAT**

Base: 88 x 444 mm  
Height: 135 mm  
Fixing: no. 3 M16  
Aluminium  
Strength: 50 kN



**T-HINGE STEEL**

Fixing: M16  
Hinge pin: M20  
Hot dip galvanised

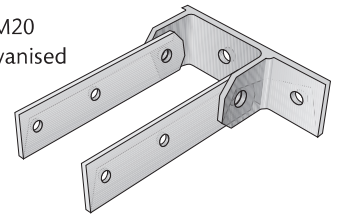

**CHAIN**

10 mm, 13 mm, 16 mm,  
20 mm, 22 mm, 25 mm  
Hot dip galvanised

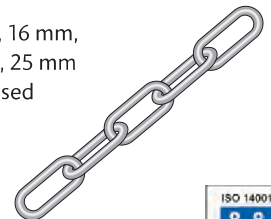

**STEEL SPRING 12 mm**

Size: 82 x 420 x 12 mm  
Galvanised

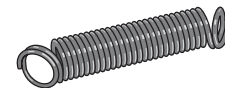

**STEEL SPRING 16 mm**

Size: 150 x 700 x 16 mm  
Painted

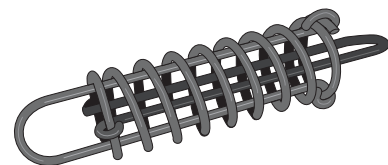

Marinetek operates a policy of continuous development and reserves the right to change specifications without notice.

Modification date: 14.11.2014

**MARINETEK GROUP OY**

Vattuniemenkatu 3  
FI-00210 Helsinki  
www.marinetek.net

TEL. +358 (0)9 682 4100  
FAX +358 (0)9 682 41030  
EMAIL info@marinetek.net

